

Karta i två blad upprättad vid avstyckning från ÅRSTA 46:1 i Uppsala

År 1976 av: *Anders Rudhe*
Anders Rudhe
Förärrättningslantmätare

Skala 1:400

FASTIGHETSÄRÄTTSLIG BESKRIVNING, arkbilaga BE 1
TEKNISK BESKRIVNING, arkbilaga BE 2

REG. MÅTTOR 3155, 3156

Trakt: ÅRSTA

REGISTRERING
Datum: 1976-04-20
Inläggning i fastighetsregistret har
verifierats. Sista utgåva.
Härav: 4 ark
För fastighetsregistreringssyftet

Lottern	A =	ÅRSTA	46:2
"	B =	"	46:3
"	C =	"	46:4
"	D =	"	46:5
"	E =	"	46:6
"	F =	"	46:7
"	G =	"	46:8
"	H =	"	46:9
"	I =	"	46:10
"	J =	"	46:11
"	K =	"	46:12
"	L =	"	46:13
"	M =	"	46:14
"	N =	"	46:15
"	O =	"	46:16
"	P =	"	46:17
"	Q =	"	46:18
"	R =	"	46:19
"	S =	"	46:20
"	T =	"	46:21
"	U =	"	46:22
"	V =	"	46:23
"	W =	"	46:24
"	X =	"	46:25
"	Y =	"	46:26
"	Z =	"	46:27
"	AA =	"	46:28
"	AB =	"	46:29
"	AC =	"	46:30
"	AD =	"	46:31
"	AE =	"	46:32
"	AF =	"	46:33
"	AG =	"	46:34
"	AH =	"	46:35
"	AI =	"	46:36
"	AL =	"	46:37
"	AM =	"	46:38
"	AN =	"	46:39
"	AO =	"	46:40
"	AP =	"	46:41
"	AR =	"	46:42
"	AS =	"	46:43
"	AU =	"	46:44
"	AV =	"	46:45
"	AX =	"	46:46
"	AY =	"	46:47
"	AZ =	"	46:48
"	BA =	"	46:49
"	BB =	"	46:50
"	BC =	"	46:51
"	BD =	"	46:52
"	BE =	"	46:53
"	BF =	"	46:54
"	BG =	"	46:55
"	BH =	"	46:56
"	BI =	"	46:57
"	BJ =	"	46:58
"	BK =	"	46:59
"	BL =	"	46:60
"	BM =	"	46:61
"	BN =	"	46:62
"	BO =	"	46:63
"	BP =	"	46:64
"	BQ =	"	46:65
"	BR =	"	46:66
"	BS =	"	46:67
"	BT =	"	46:68
"	BV =	"	46:69
"	BW =	"	46:70
"	BX =	"	46:71
"	BY =	"	46:72
"	BZ =	"	46:73
"	CA =	"	46:74
"	CB =	"	46:75
"	CC =	"	46:76
"	CD =	"	46:77
"	CE =	"	46:78
"	CF =	"	46:79
"	CG =	"	46:80
"	CH =	"	46:81
"	CI =	"	46:82
"	CJ =	"	46:83
"	CK =	"	46:84
"	CL =	"	46:85
"	CM =	"	46:86
"	CN =	"	46:87
"	CO =	"	46:88
"	CP =	"	46:89
"	CQ =	"	46:90
"	CR =	"	46:91
"	CS =	"	46:92
"	CT =	"	46:93
"	CU =	"	46:94
"	CV =	"	46:95
"	CX =	"	46:96
"	CY =	"	46:97
"	CZ =	"	46:98
"	DA =	"	46:99
"	DB =	"	46:99
"	DC =	"	46:99

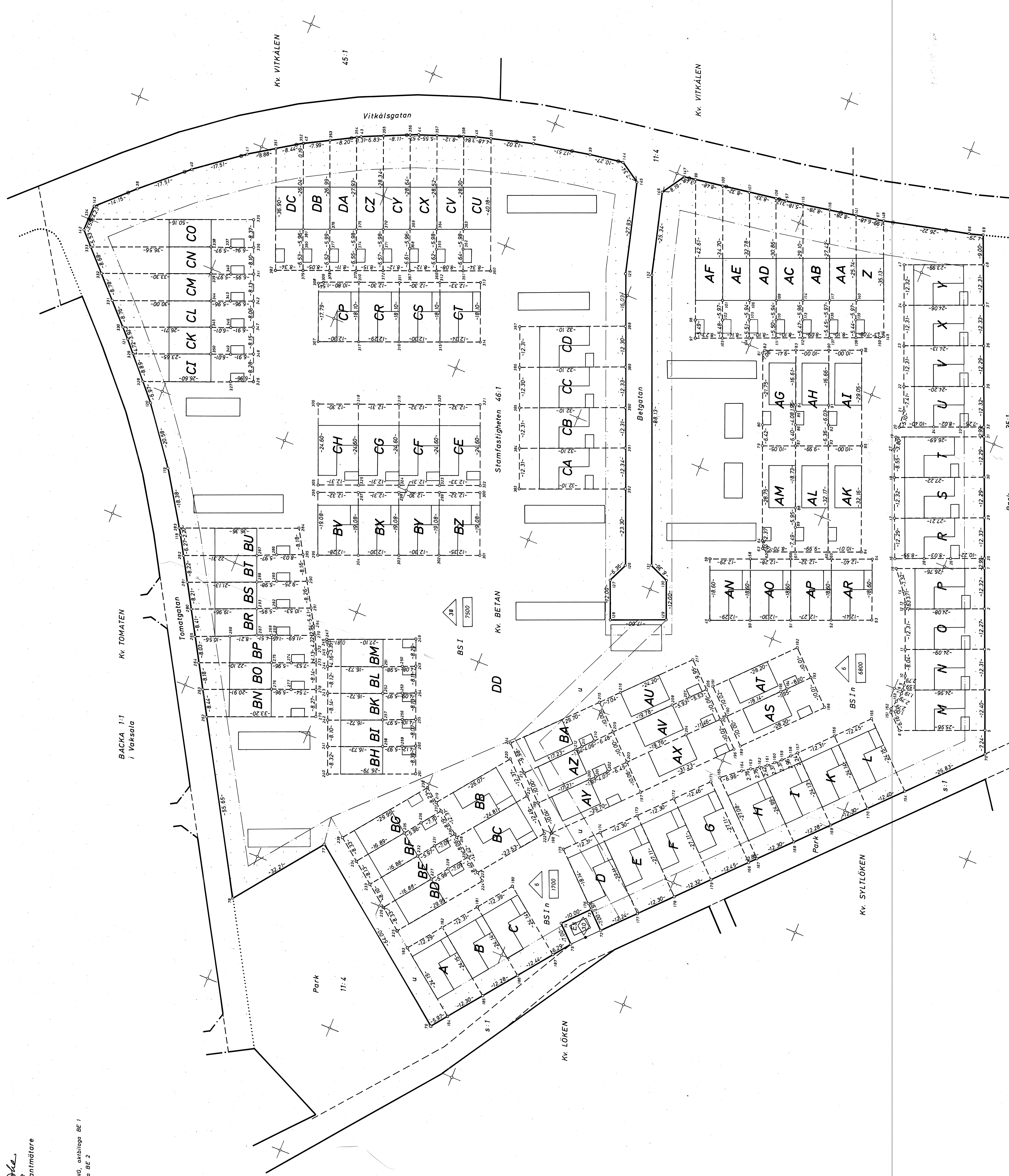

Nyutskurna gränser:
Samtliga — — mellan
numrerade punkter